

PARCEL BOUNDARIES

CITY OF STAPLES

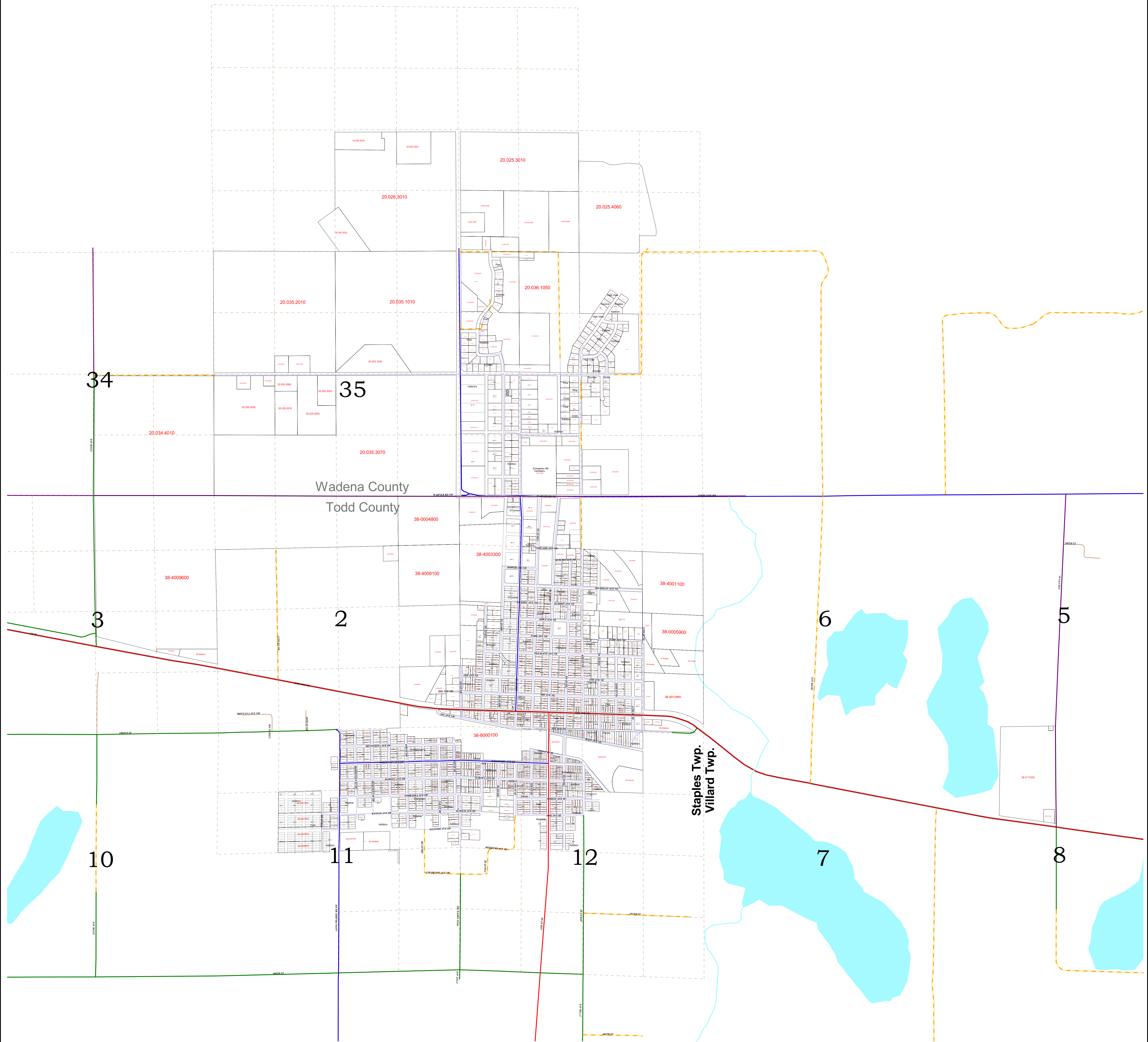
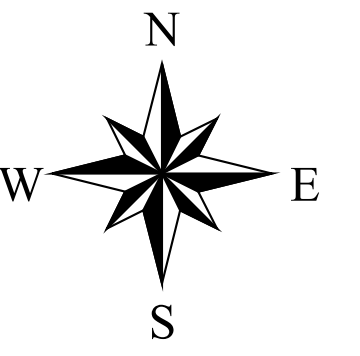

0.25 0 0.25 0.5 Miles

1 inch = 550 ft

- | | | | |
|---------------------|--------------------|--|-----------------|
| | Parcels | | CSAH-Paved |
| | Platted Lots | | CSAH-Gravel |
| | PLS Lines | | TWP-Paved |
| | County Line | | TWP-Gravel |
| Road Network | | | TWP-Min. Maint. |
| | US-Paved | | Municipal |
| | State Highway | | Private Road |
| | County Road-Paved | | |
| | County Road-Gravel | | |

This Map is a representation of Staples Tax Parcels based on interpretation of data available at the Todd County Court house and a limited amount of field collected data. Parcels were developed using Coordinate Geometry where surveys were available. Also referenced 2003 FSA aerial photographs. GPS collection of section corners data was gathered using sub-meter accuracy.

Parcels: City of Staples, developed by Pro West and Associates, updated by Todd County GIS & Land Services
 Road Network: Todd County 911/Rural Addressing Basemap

Map is to be used as a reference only. Not to be used as a legal document.

The Todd County GIS Department has made every effort to provide the most up-to-date information available in this publication and cannot be held responsible for any unforeseen errors.



TODD COUNTY
 GIS DEPARTMENT
 215 FIRST AVENUE SOUTH
 SUITE 202
 LONG PRAIRIE, MN 56347
 OFFICE: (320) 732-4248
 FAX: (320) 732-6345
 E-MAIL: TODD@S@CO.TODD.MN.US
 NOVEMBER, 2005